

NOTES (UNLESS OTHERWISE SPECIFIED):

1. PAINT FRONT SURFACE OF CAP ONLY USING EPOXY INK, COLOR RED.
2. MARK PIN DESIGNATIONS IN WHITE AND MAC PANEL PART NUMBER AS SHOWN, COLOR BLACK. (SILKSCREEN P/N 1542-01).
3. INSTALL LOCATING NUB, P/N 10682-02, USING SHAFT BONDING LOCTITE, P/N 10584-01, AFTER FINISH.
4. BAG AND TAG 440K45 2X.

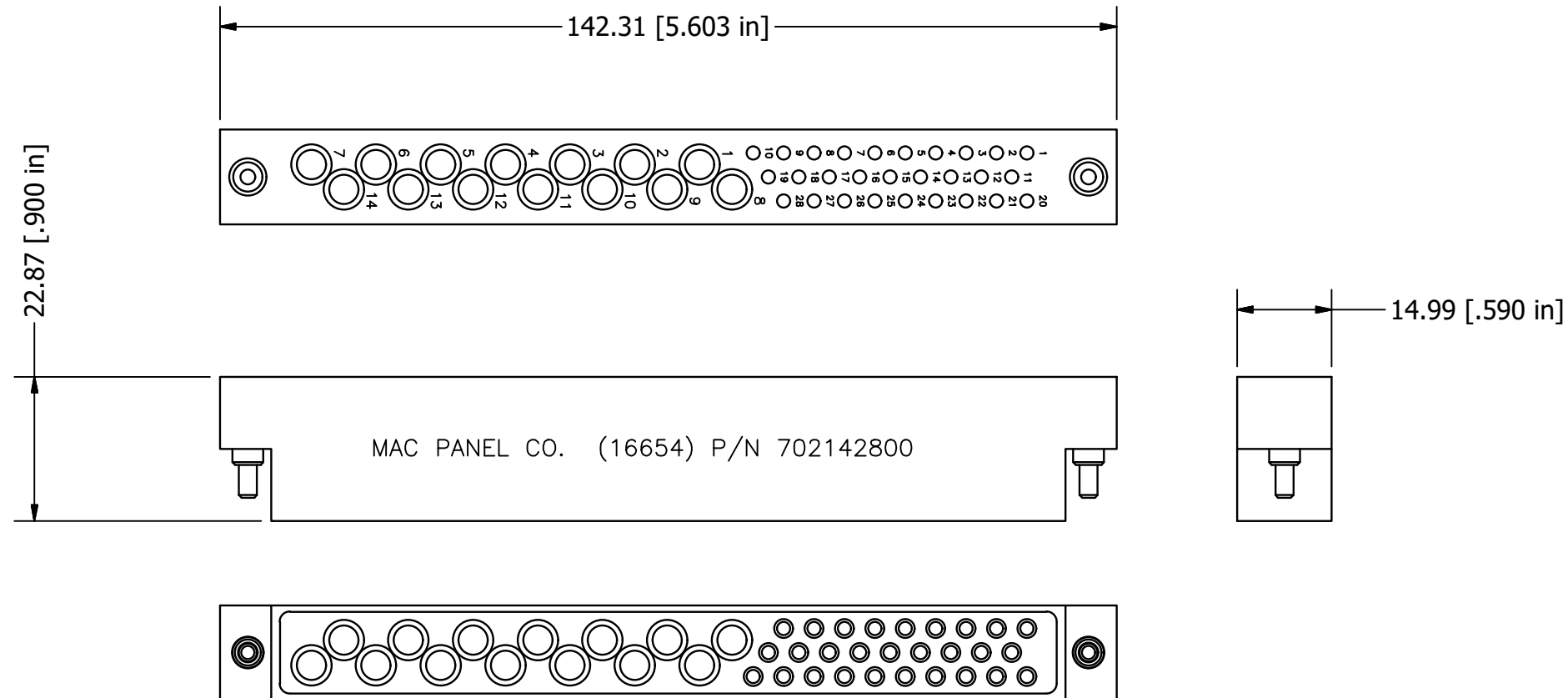

Item	Qty	Part Number	Description
1	2	10682-02	LOCATING NUB (STAINLESS STEEL)
2	2	440K45	SCREW
3	1	702142800B	MODULE BODY, ITA

REV LEVEL OF SHEETS				
REV	DATE	BY	APP	SHEET

THIRD ANGLE PROJECTION

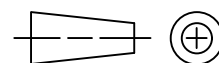

MAC PANEL PROPRIETARY
 This document may contain confidential and proprietary information that is the property of MAC Panel Company that may not be disclosed to, or duplicated for others except as authorized by MAC Panel Company.

UNLESS OTHERWISE SPECIFIED

* TOLERANCES, MACHINED:	SHEET METAL:
ANGLES ±1°	ANGLES ±1°
.XXX ±.005	.XXX ±.010
.XX ±.01	.XX ±.03
DIA. ±.002	DIA. ±.005

* Parenthetical information is for reference only.

DRAWN	MANESS, W.K.	03/07/00
CHECKED	-	-
ENGINEER	MANESS, W.K.	03/07/00
RELEASED	SIMMONS, V.L.	03/16/00
Q/C	-	-
USED ON:	-	

○○○○○○○○ MAC-PANEL MAC PANEL COMPANY HIGH POINT, NC 27264		
TITLE MODULE ASSEMBLY, MINI-POWER/SIGNAL, ITA 14/28 POSITION, S/64		
SIZE	CODE IDENT	DRAWING NO.
B	16654	702142800
SCALE 1/1	-	SHEET 1 OF 1