

- NOTES:
- 1 FINISH: SILKSCREEN FRONT FACE ONLY, USING EPOXY INK, COLOR BLACK.
  - 2 CONTACT DESIGNATIONS TO BE SILKSCREENED USING EPOXY INK, COLOR WHITE, FRONT FACE ONLY, OR LASER ENGRAVE THRU INK.
  - 3 MARK PART NUMBER WITH CORRESPONDING DASH NUMBER IN APPROXIMATE LOCATION SHOWN, EPOXY INK, COLOR BLACK, PER MIL-STD-130, OR LASER ENGRAVE.
4. APPLY GREEN LOCTITE TO P/N 632CSC-01 AND 632CSB-01 & -02. AFTER FULLY ASSEMBLED, RUN THROUGH SILKSCREENED DRYER, CHECK ASSEMBLY, MAKE SURE LOCTITTED PARTS ARE FREE SPINNING.
  5. USE SILKSCREEN P/N 1608-01. OR LASER ENGRAVE TEXT.

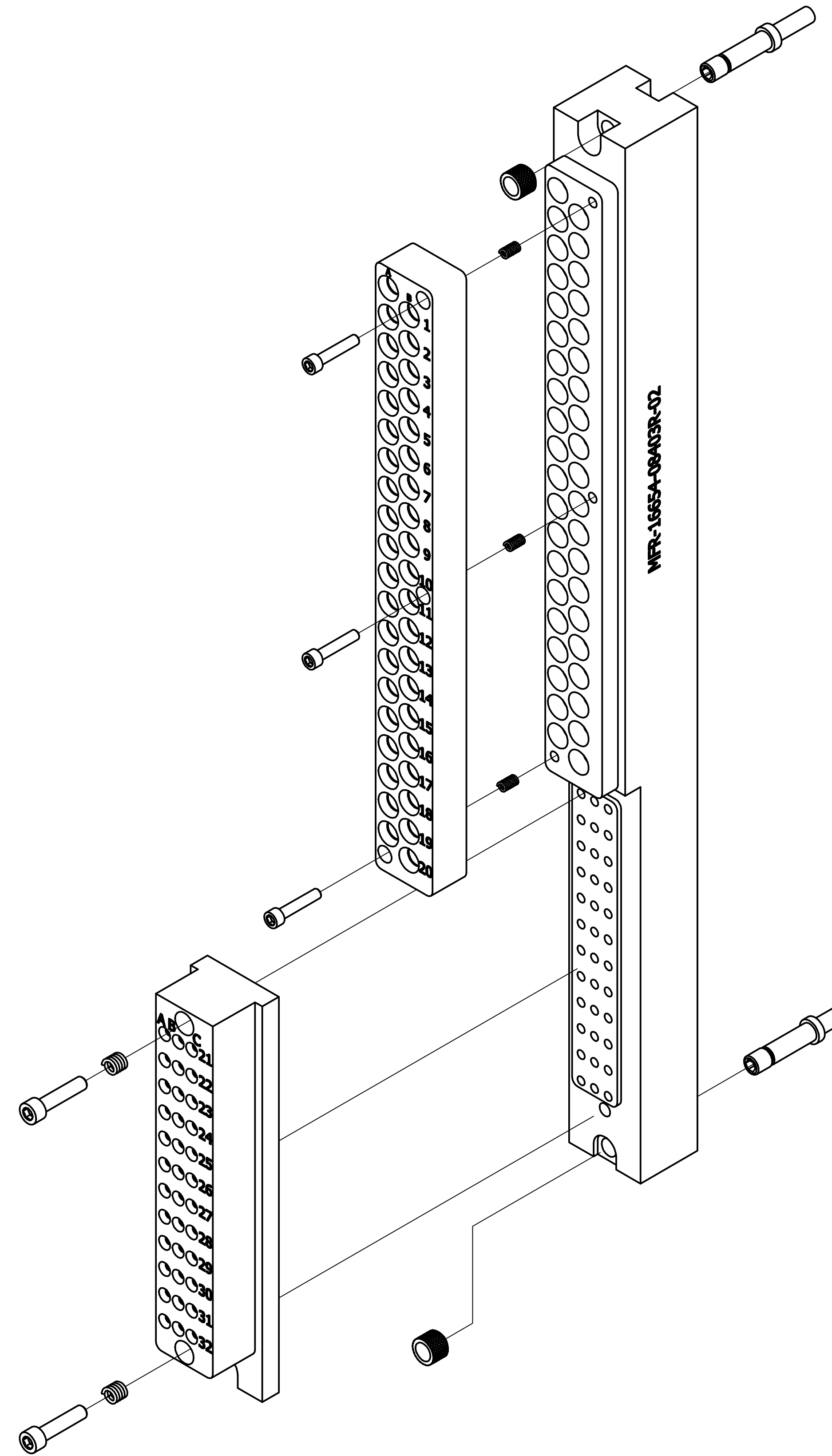
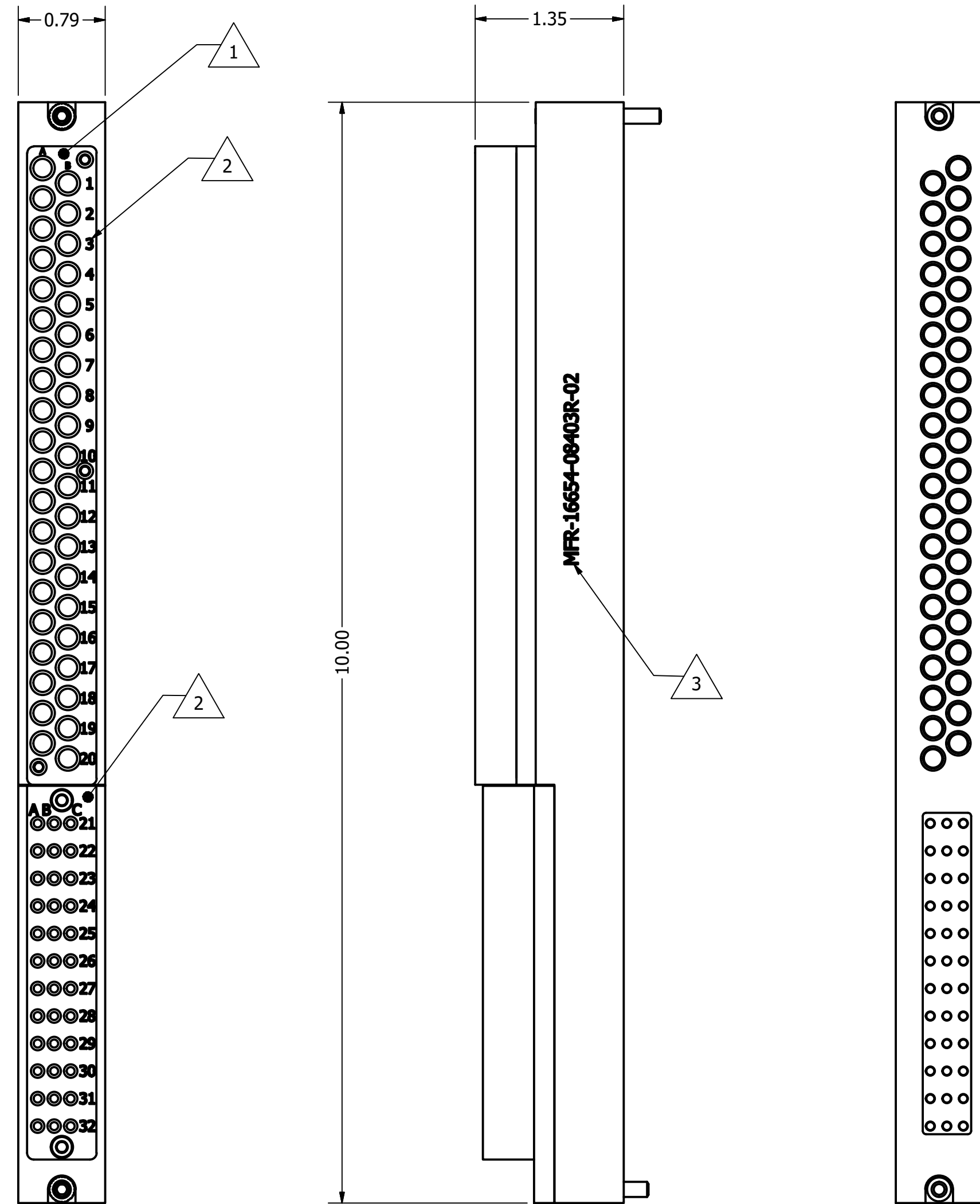

BALLOON LEGEND	
PART NUMBER	QTY

TOLERANCES (UNLESS OTHERWISE SPECIFIED)			
SHEET METAL	MACHINED	Third Angle Projection	
ANGLES ± 1°	ANGLES ± 1°		
.XX ± .03	.XX ± .01		
.XXX ± .010	.XXX ± .005		
.XXXX ± .005	.XXXX ± .0005		

REMOVE ALL BURRS AND BREAK SHARP EDGES.

DRAWN BY HERNANDEZ ENGINEERING	18/01/2017	MAC PANEL COMPANY - HIGH POINT, NC	
OPERATIONS		TITLE	
MANUFACTURING		MDL ASSY RCVR, 40 POSN SIG, 36 POSN PWR, DISC	
ASSEMBLY			
MATERIAL USED			
SIZE D	CAGE CODE 16654	DWG NO 08403R-02-CU	REV E
SCALE	SPN:	SHEET 1 OF 1	